

SPECIFICATIONS:

MODEL NUMBER: 8010-101-201

PUMP DESIGN: Positive Displacement 3 Chamber Diaphragm Pump

CAM: 2.0 Degree

MOTOR: Permanent Magnet, P/N 11-155-00

VOLTAGE: 24 VAC Nominal

PRESSURE SWITCH: None

LIQUID TEMPERATURE: 180 Degrees Fahrenheit (82 Degrees Centigrade) Max.

PRIME: Self-Priming Up To 4.0 Ft. Vertical,
Max. Inlet Pressure 30 PSI (2.1 Bar)

PORTS: 3/8"-18 NPT Female

MATERIAL OF CONSTRUCTION:

PLASTICS- Nylon

VALVES- EPDM

DIAPHRAGM- Santoprene

FASTENERS- Stainless Steel

NET WEIGHT: 4.7 Lbs (2.13 Kg)

DUTY CYCLE: Continuous (See Temperature Rise Chart)

APPROVALS: N.S.F. Listed

TYPICAL APPLICATIONS: R.O. Booster Pump

BYPASS: 60 PSI Springs

DIMENSIONS:

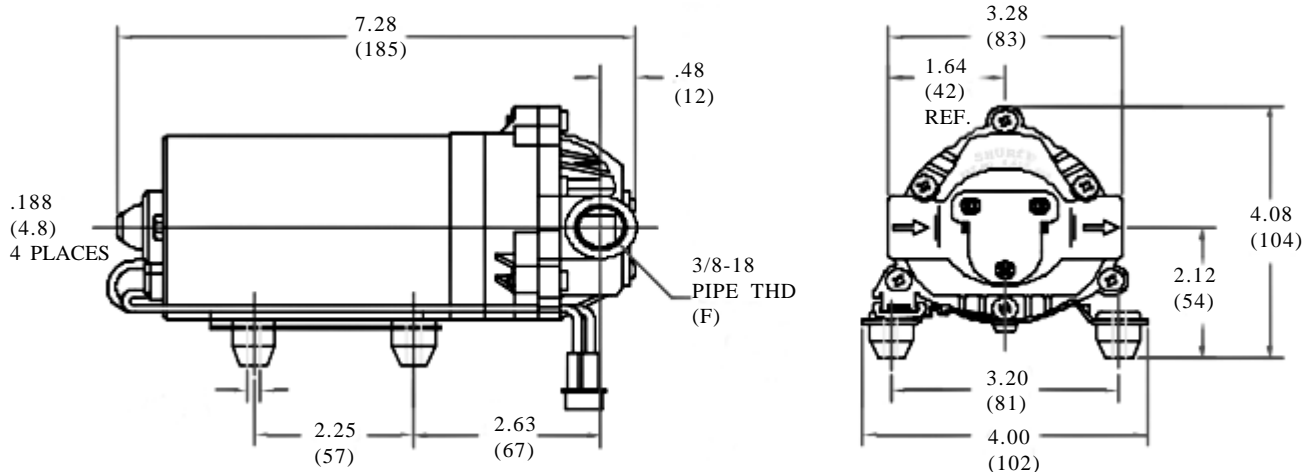

TEMPERATURE RISE

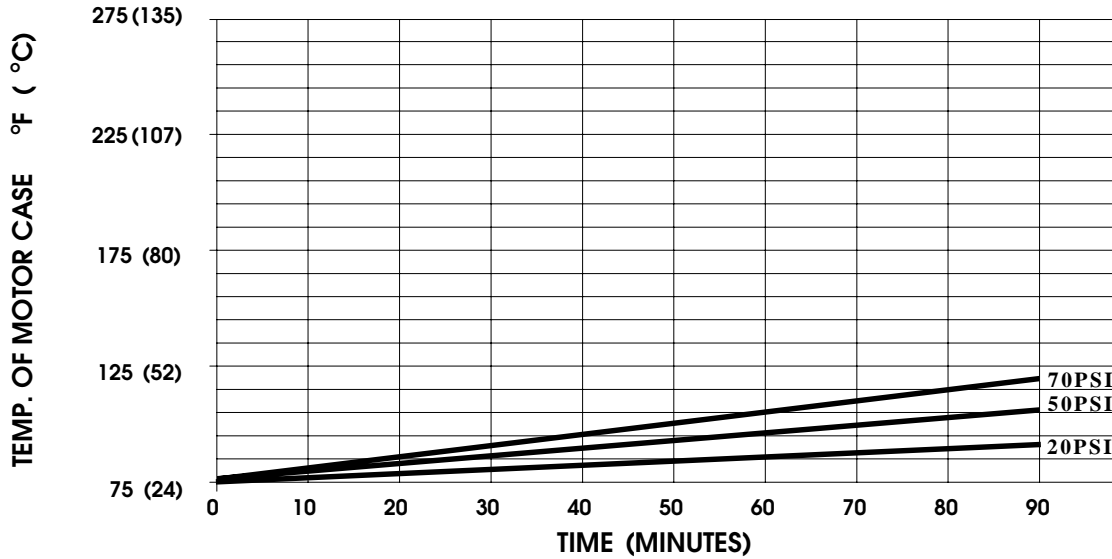

THIS GRAPH IS FOR USE AS A DESIGN GUIDE. IT IS BASED ON RUNNING CONTINUOUSLY WITH AN AMBIENT TEMPERATURE OF 70° F IN STILL AIR.

TYPICAL PERFORMANCE

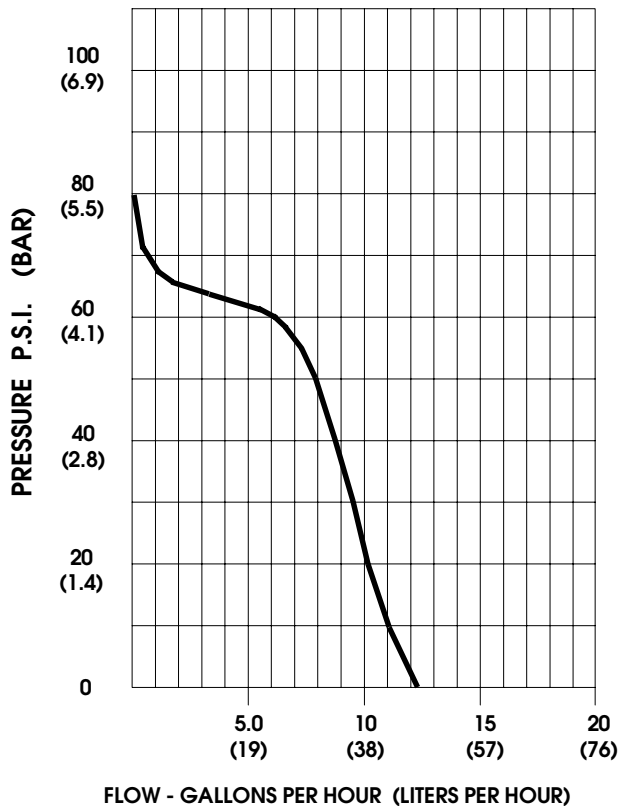

PRESSURE (PSI)	FLOW (GPH/LIT)	RPM MIN/MAX	CURRENT (AMPS)	VOLTAGE (VOLTS)
OPEN	12.3/46	470/475	0.15	24 VAC
10	11.0/42	450/455	0.18	"
20	10.1/38	430/435	0.23	"
30	9.4/36	415/420	0.25	"
40	8.7/33	395/400	0.30	"
50	8.0/30	380/385	0.34	"
60	6.2/23	370/380	0.37	"
70	0.8/3.0	350/375	0.39	"
80	0.2/0.7	345/375	0.49	"

-SPECIFICATIONS SUBJECT TO CHANGE WITHOUT NOTICE.

-ALL DATA BASED ON TESTING WITH WATER.