

SPECIFICATIONS:

- MODEL NUMBER:** 8005-991-820
- PUMP DESIGN:** Positive Displacement 3 Chamber Diaphragm Pump
- CAM:** 2.5 Degree
- MOTOR:** Permanent Magnet, P/N 11-237-00
- VOLTAGE:** 24VAC Nominal
- PRESSURE SWITCH:** None
- LIQUID TEMPERATURE:** 180 Degrees Fahrenheit (82 Degrees Centigrade) Max.
- PORTS:** 3/8"-18 NPT Female
- MATERIAL OF CONSTRUCTION:**
 - PLASTICS-** Nylon
 - VALVES-** EPDM
 - DIAPHRAGM-** Santoprene
 - FASTENERS-** Stainless Steel
- NET WEIGHT:** 5.8 Lbs (2.6 Kg)
- DUTY CYCLE:** Continuous (See Temperature Rise Chart)
- APPROVALS:** NSF Listed
- TYPICAL APPLICATIONS:** R.O. Booster Pump
- BYPASS:** 45 PSI

DIMENSIONS:

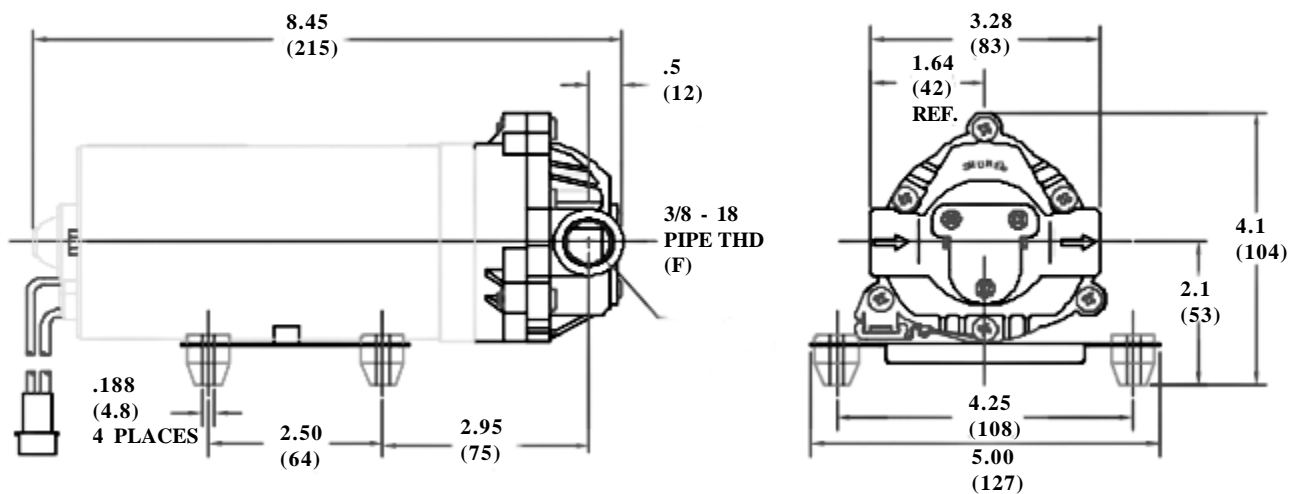

TEMPERATURE RISE

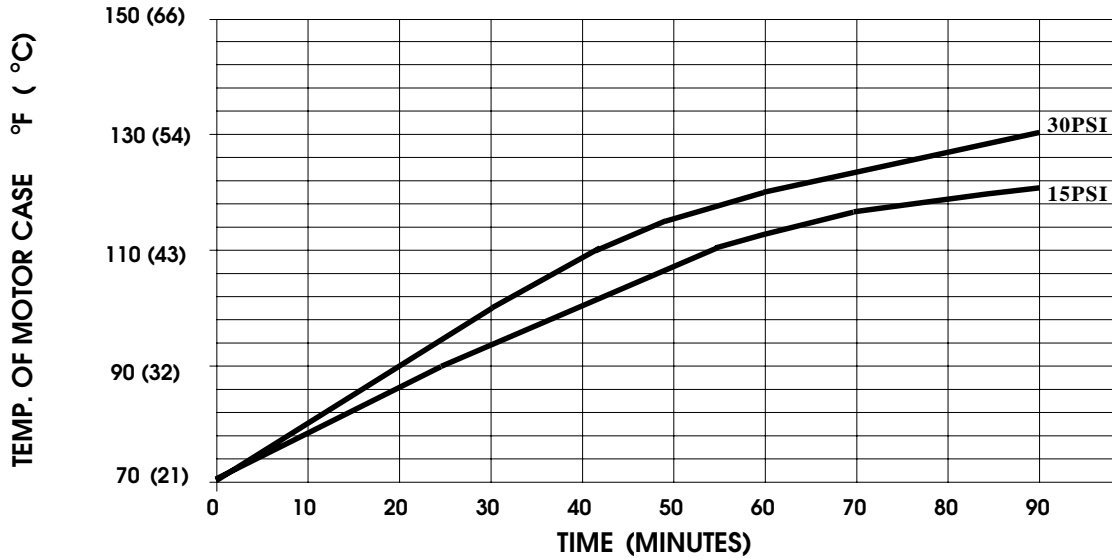

THIS GRAPH IS FOR USE AS A DESIGN GUIDE. IT IS BASED ON RUNNING CONTINUOUSLY WITH AN AMBIENT TEMPERATURE OF 70 °F IN STILL AIR.

TYPICAL PERFORMANCE

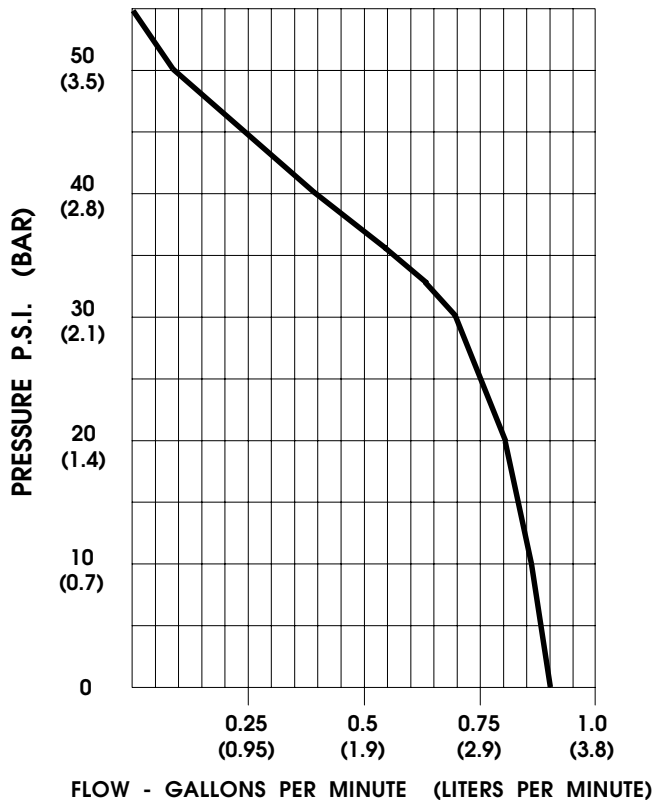

| PRESSURE (PSI) | FLOW (GPM/LIT) | RPM MIN/MAX | CURRENT (AMPS) | VOLTAGE (VOLTS) |
|----------------|----------------|-------------|----------------|-----------------|
| OPEN | 0.90/3.4 | 1550/1570 | 1.0 | 24VAC |
| 10 | 0.86/3.3 | 1440/1470 | 1.2 | " |
| 20 | 0.81/3.1 | 1400/1410 | 1.4 | " |
| 30 | 0.68/2.6 | 1350/1370 | 1.6 | " |
| 40 | 0.37/1.4 | 1315/1320 | 1.8 | " |
| 50 | 0.08/0.3 | 1270/1280 | 2.0 | " |

**-SPECIFICATIONS SUBJECT TO CHANGE WITHOUT NOTICE.
-ALL DATA BASED ON TESTING WITH WATER AT AMBIENT TEMPERATURE.**